

Typical Performance:

	Sealed Orifice	Orifice Loading	Max. Eff.
Orifice	0	19mm	23mm
Vacuum Pressure (mBar)	231	143	114
Air Flow ( CFM )	0	56.9	75
Airwatt (watt)	-	382	405
Speed (rpm)	28431	23900	23198
Input Power (watt)	877	1200	1221
Efficiency (%)	-	32.7%	33.2%

Typical Performance:

	Sealed Orifice	Orifice Loading	Max. Eff.
Orifice	0	19mm	23mm
Vacuum Pressure (mBar)	233	145	115
Air Flow ( CFM )	0	57.1	75
Airwatt (watt)	-	386	408
Speed (rpm)	28012	23157	22980
Input Power (watt)	881	1178	1232
Efficiency (%)	-	32.7%	33.1%



Motor Code MLGS23120 -05SA

**Application**

Wet & Dry  
Industrial Vacuum

**Characteristic**

Voltage: 230V, 50/60Hz  
Fan system: Bypass Peripheral, 5.7 Inch, 2 stages  
Weight: 2150 g  
Certification: Provision for Grounding  
Feature: Air seal, coated Fan Shell, Interrupted brush



Motor Code MLGS12120 -05SA

**Application**

Wet & Dry  
Industrial Vacuum

**Characteristic**

Voltage: 120V, 50/60Hz  
Fan system: Bypass Peripheral, 5.7 Inch, 2 stages  
Weight: 2170 g  
Certification: Provision for Grounding  
Feature: Air seal, coated Fan Shell, Interrupted brush

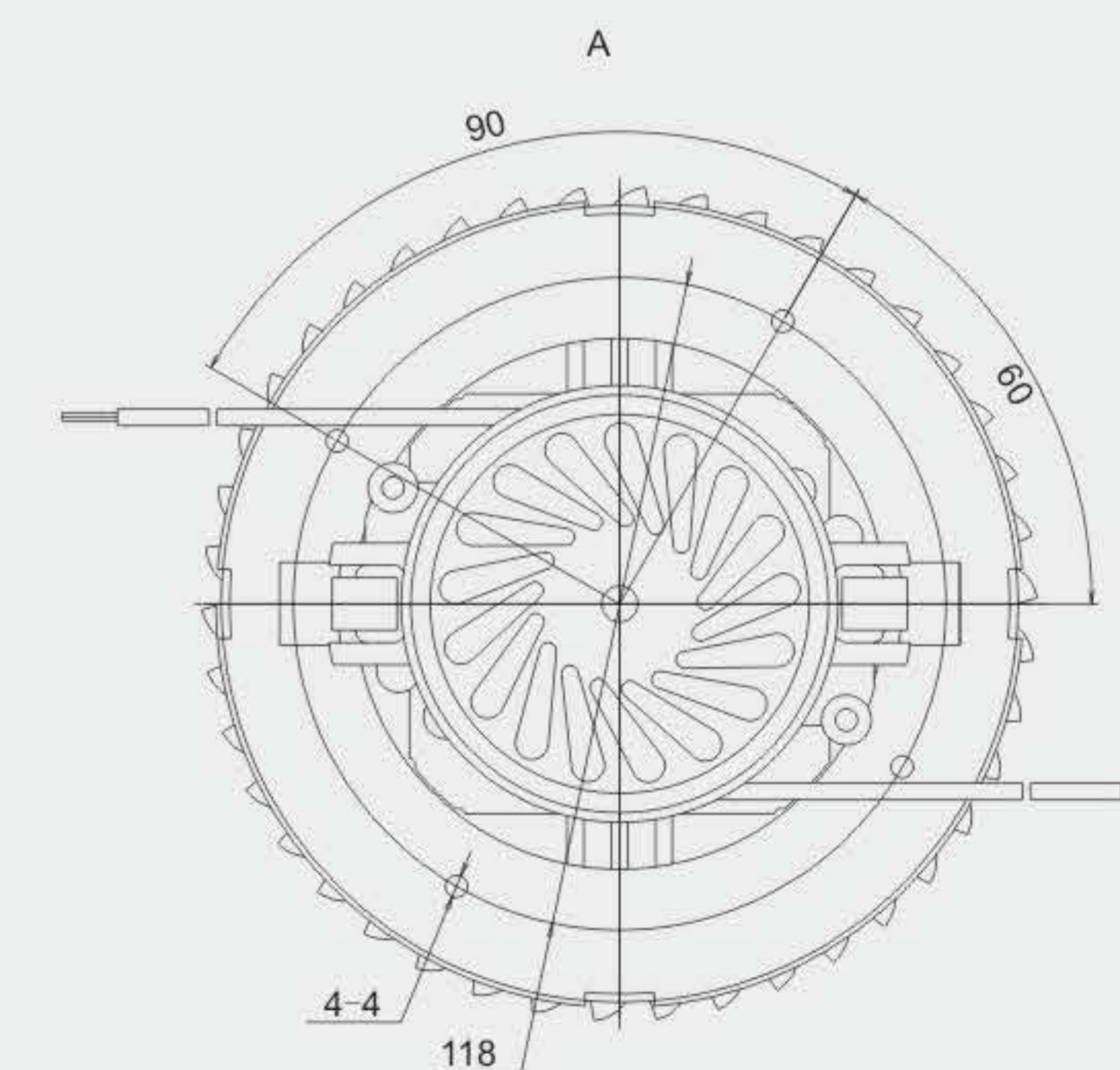
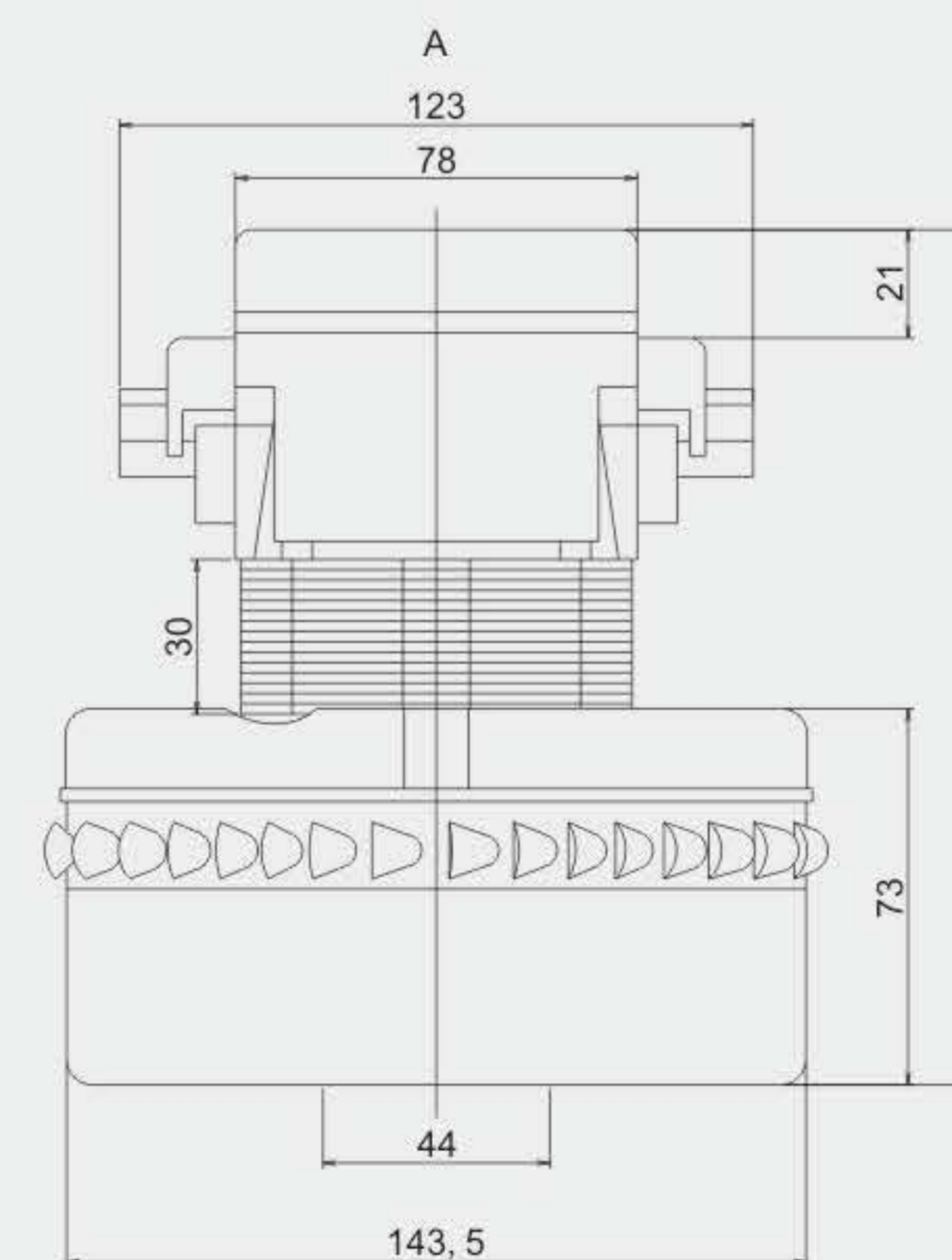
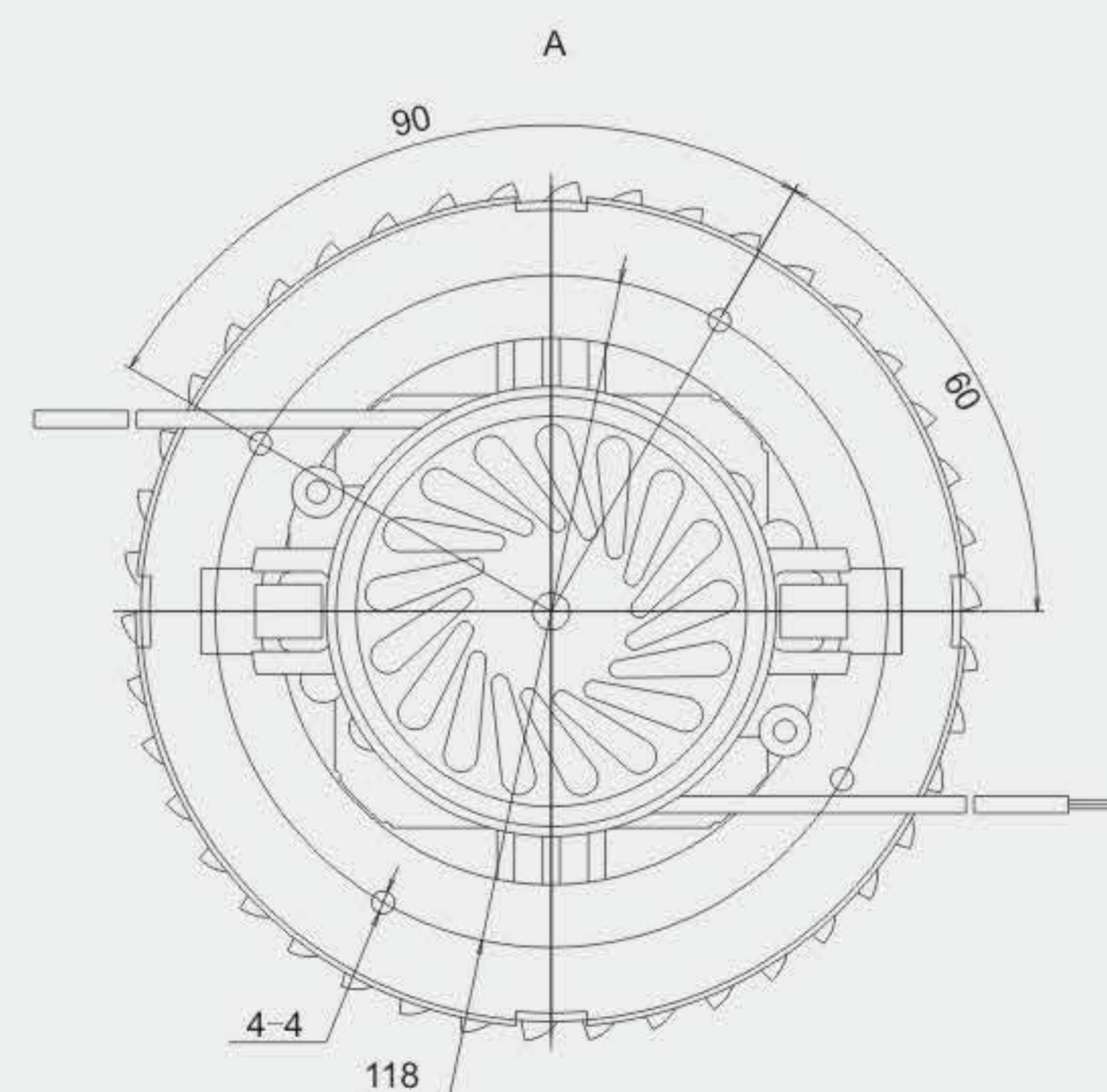
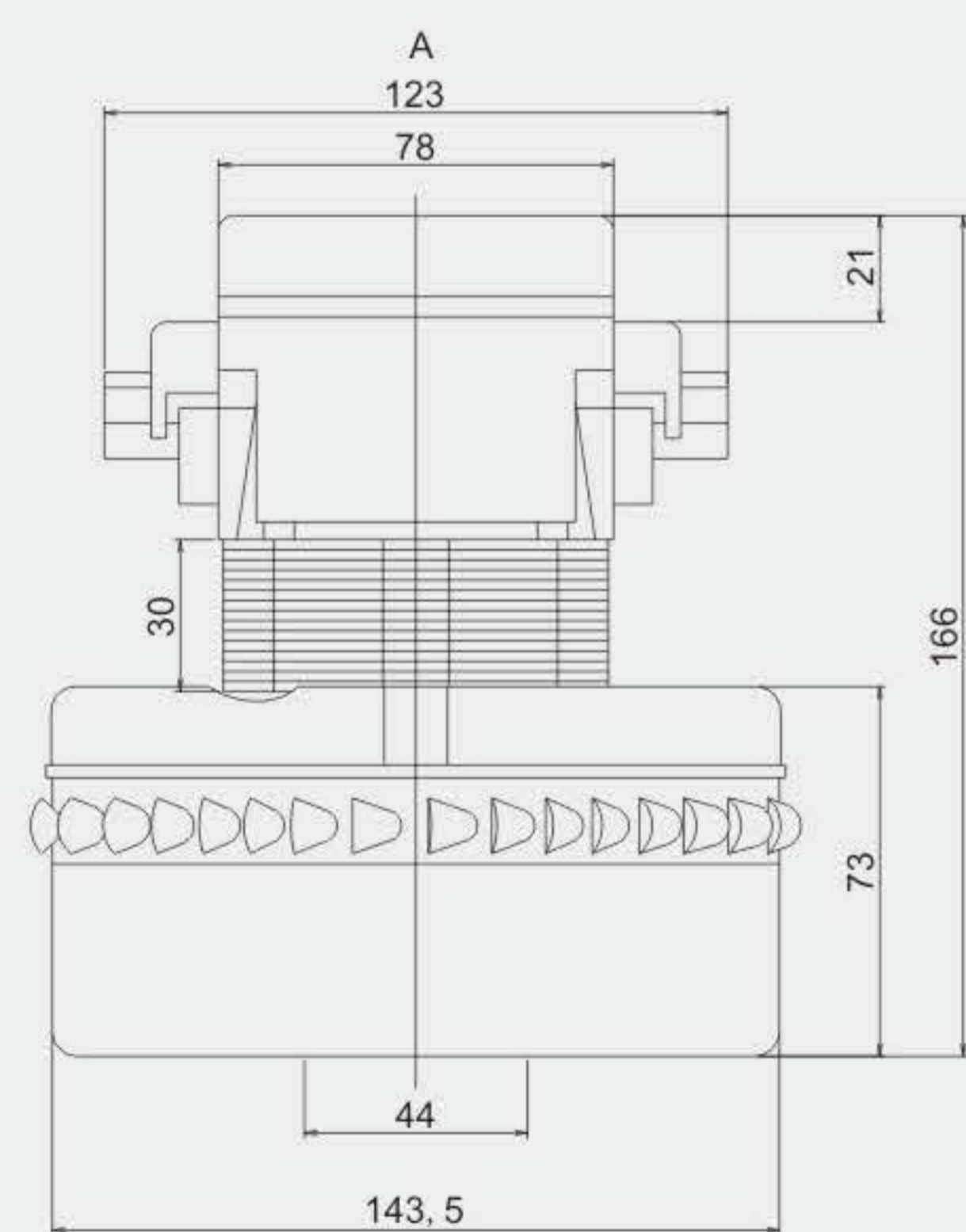

Typical Performance:

	Sealed Orifice	Orifice Loading	Max. Eff.
Orifice	0	19mm	19mm
Vacuum Pressure (mBar)	200	119	119
Air Flow ( CFM )	-	52.3	52.3
Airwatt (watt)	-	282	282
Speed (rpm)	26051	20940	20940
Input Power (watt)	756	972	972
Efficiency (%)	-	29.1%	29.1%

Typical Performance:

	Sealed Orifice	Orifice Loading	Max. Eff.
Orifice	0	19mm	19mm
Vacuum Pressure (mBar)	197	115	115
Air Flow ( CFM )	-	51.9	51.9
Airwatt (watt)	-	278	278
Speed (rpm)	25882	21456	21456
Input Power (watt)	732	944	944
Efficiency (%)	-	29.5%	29.5%



Motor Code MLGS23100 -03SA

**Application**

Wet & Dry  
Industrial Vacuum  
Carpet Extractor

**Characteristic**

Voltage: 230V, 50/60Hz  
Fan system: Bypass Peripheral, 5.7 Inch, 2 stages  
Weight: 2071 g  
Certification: Provision for Grounding  
Feature: Air seal, coated Fan Shell, Interrupted brush



Motor Code MLGS12100 -03SA

**Application**

Wet & Dry  
Industrial Vacuum  
Carpet Extractor

**Characteristic**

Voltage: 120V, 50/60Hz  
Fan system: Bypass Peripheral, 5.7 Inch, 2 stages  
Weight: 2068 g  
Certification: Provision for Grounding  
Feature: Air seal, coated Fan Shell, Interrupted brush

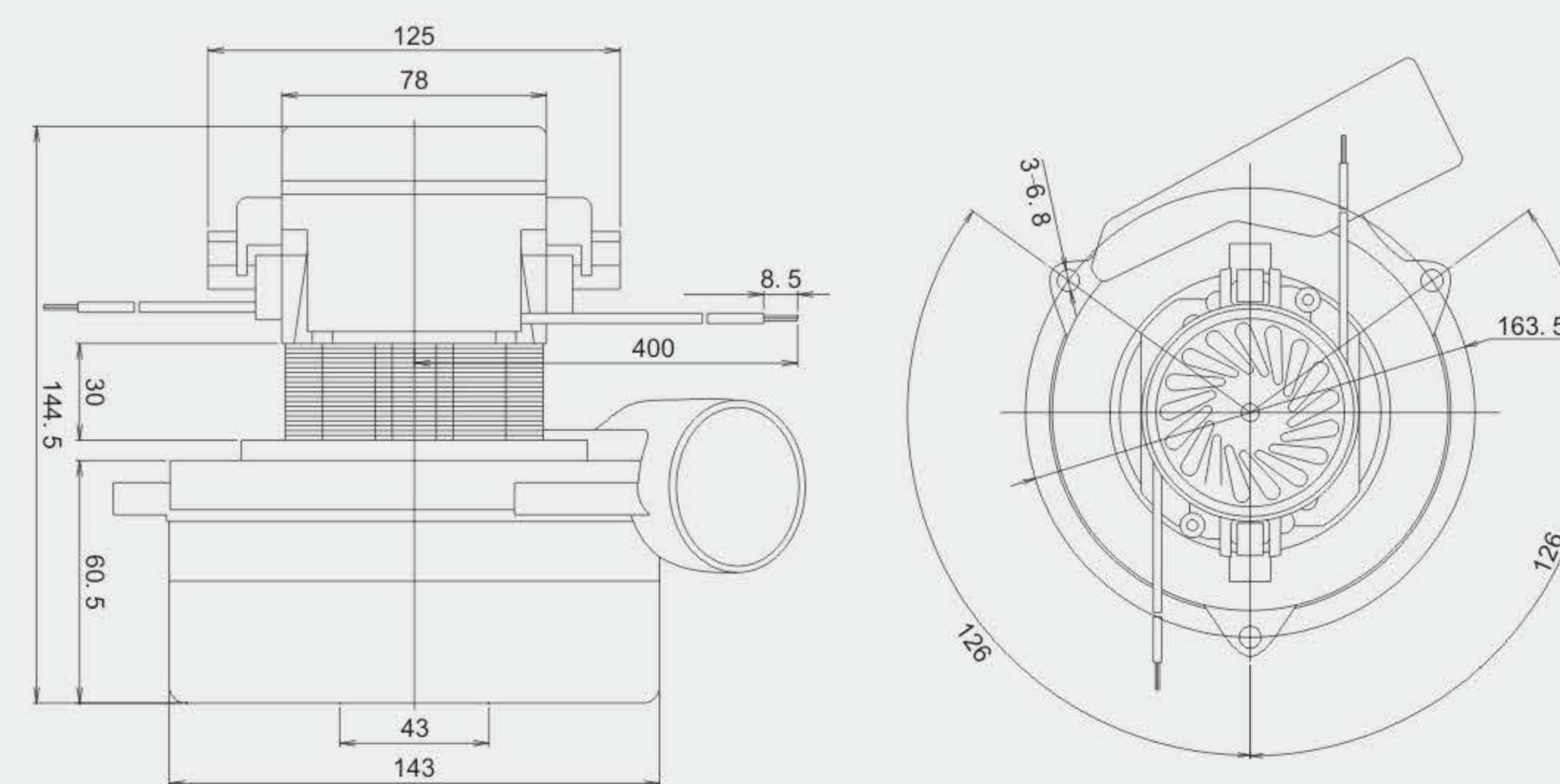
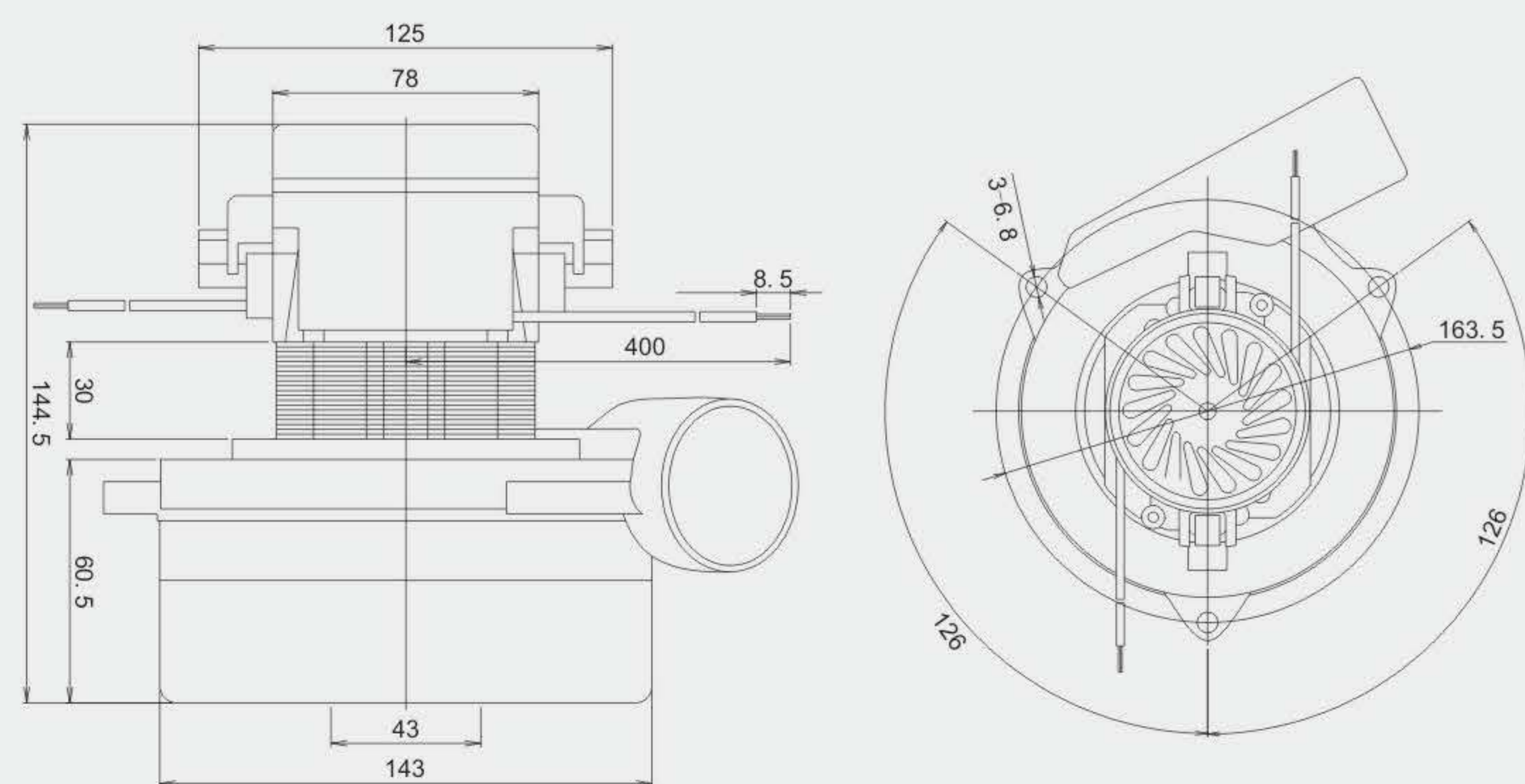

Typical Performance:

	Sealed Orifice	Orifice Loading	Max. Eff.
Orifice	0	19mm	19mm
Vacuum Pressure (mBar)	134	59.5	59.5
Air Flow (CFM)	0	37.5	37.5
Airwatt (watt)	-	105	105
Speed (rpm)	17199	13358	13358
Input Power (watt)	367	431	431
Efficiency (%)	-	24.4%	24.4%

Typical Performance:

	Sealed Orifice	Orifice Loading	Max. Eff.
Orifice	0	19mm	19mm
Vacuum Pressure (mBar)	183	81	81
Air Flow (CFM)	-	41	41
Airwatt (watt)	-	156	156
Speed (rpm)	16640	13230	13230
Input Power (watt)	440	606	606
Efficiency (%)	-	25.7%	25.7%



Motor Code MLGS2440-05SA-GT

Application

Scrubber

Characteristic

Voltage: 24V

Fan system: Bypass Peripheral, 5.7 Inch, 2 stages

Weight: 1967 g

Certification: Provision for Grounding

Feature: Air seal, coated Fan Shell, Interrupted brush



Motor Code MLGS2460-05MA-GT

Application

Scrubber

Characteristic

Voltage: 24V

Fan system: Bypass Peripheral, 5.7 Inch, 3 stages

Weight: 2730 g

Certification: Provision for Grounding

Feature: Air seal, coated Fan Shell, Interrupted brush

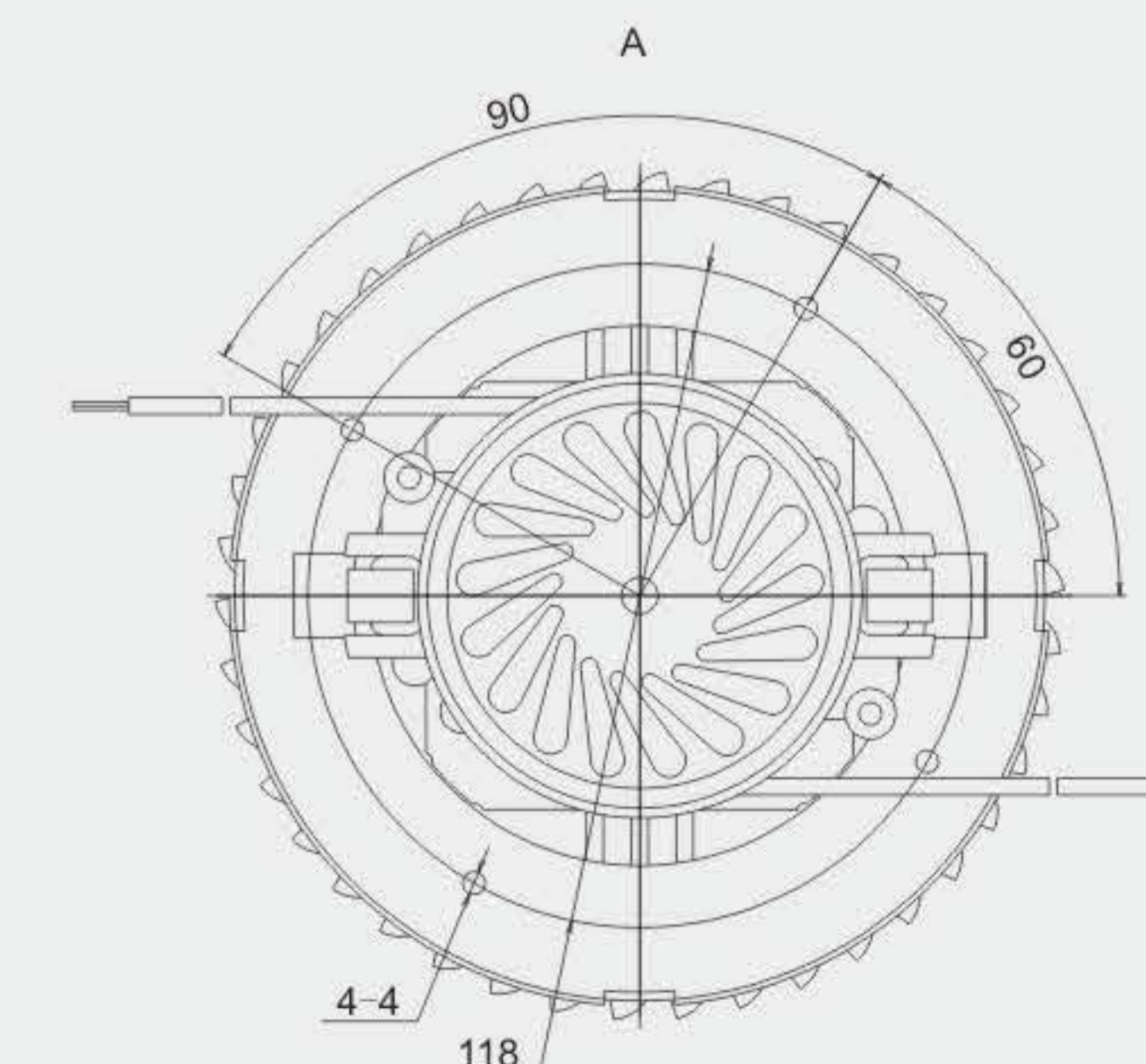
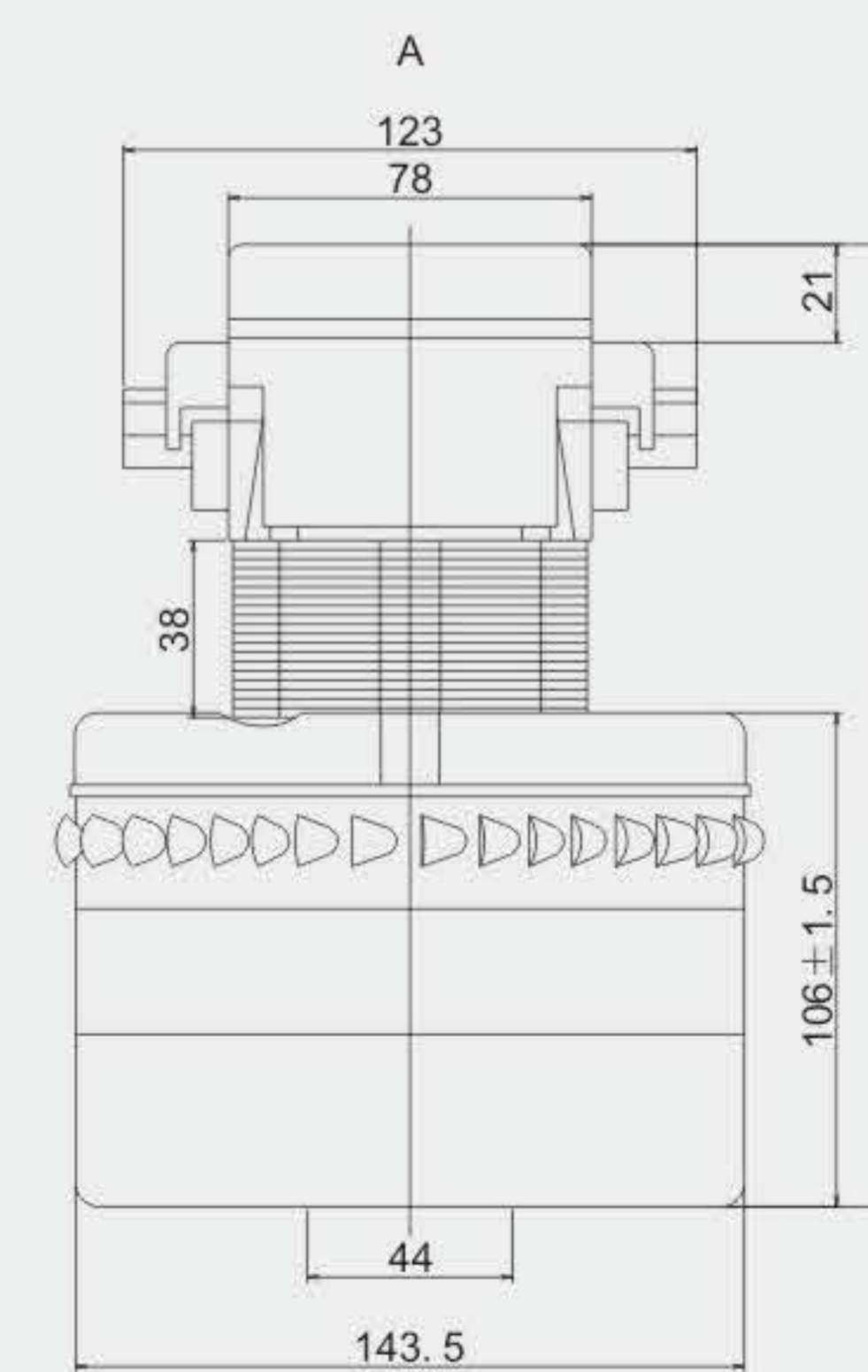
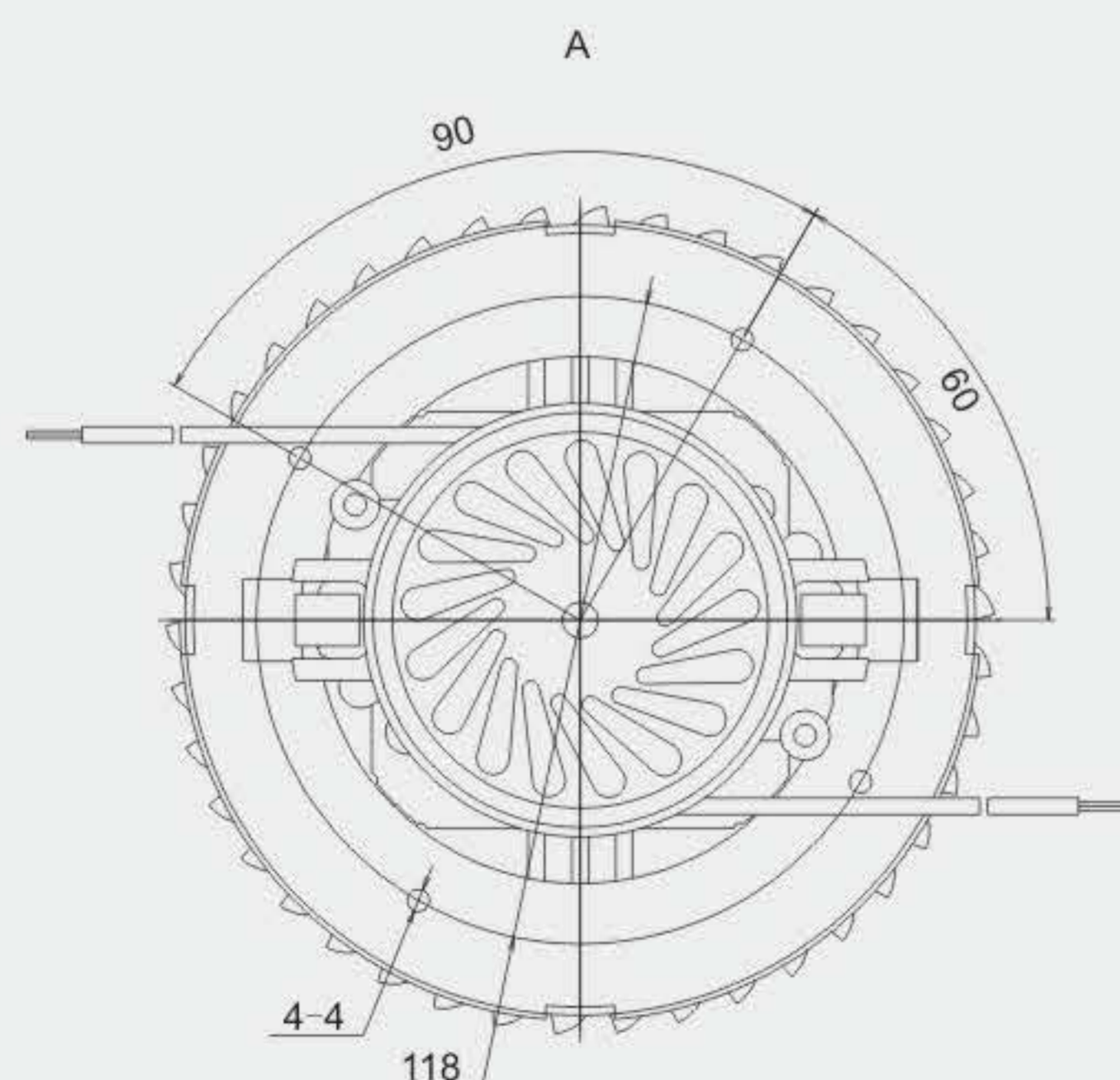
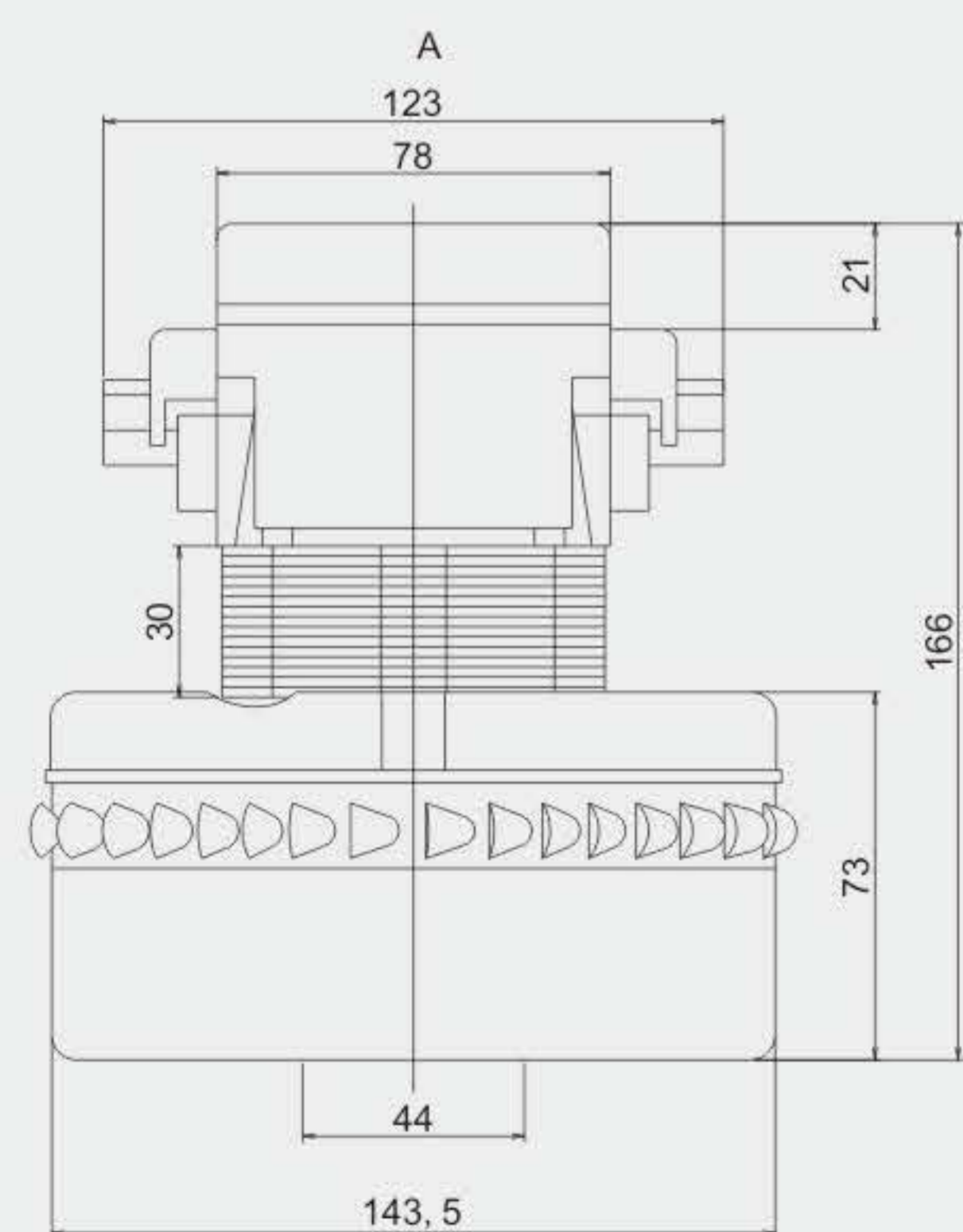

Typical Performance:

	Sealed Orifice	Orifice Loading	Max. Eff.
Orifice	0	19mm	19mm
Vacuum Pressure (mBar)	134	59.5	59.5
Air Flow (CFM)	0	37.5	37.5
Airwatt (watt)	-	105	105
Speed (rpm)	17199	13358	13358
Input Power (watt)	367	431	431
Efficiency (%)	-	24.4%	24.4%

Typical Performance:

	Sealed Orifice	Orifice Loading	Max. Eff.
Orifice	0	19mm	19mm
Vacuum Pressure (mBar)	183	81	81
Air Flow (CFM)	-	41	41
Airwatt (watt)	-	156	156
Speed (rpm)	16640	13230	13230
Input Power (watt)	440	606	606
Efficiency (%)	-	25.7%	25.7%



Motor Code MLGS2440-03SA-GT

**Application**

Scrubber

**Characteristic**

Voltage: 24V

Fan system: Bypass Peripheral, 5.7 Inch, 2 stages

Weight: 2260 g

Certification: Provision for Grounding

Feature: Air seal, coated Fan Shell, Interrupted brush



Motor Code MLGS2460-03MA-GT

**Application**

Scrubber

**Characteristic**

Voltage: 24V

Fan system: Bypass Peripheral, 5.7 Inch, 3 stages

Weight: 2740 g

Certification: Provision for Grounding

Feature: Air seal, coated Fan Shell, Interrupted brush

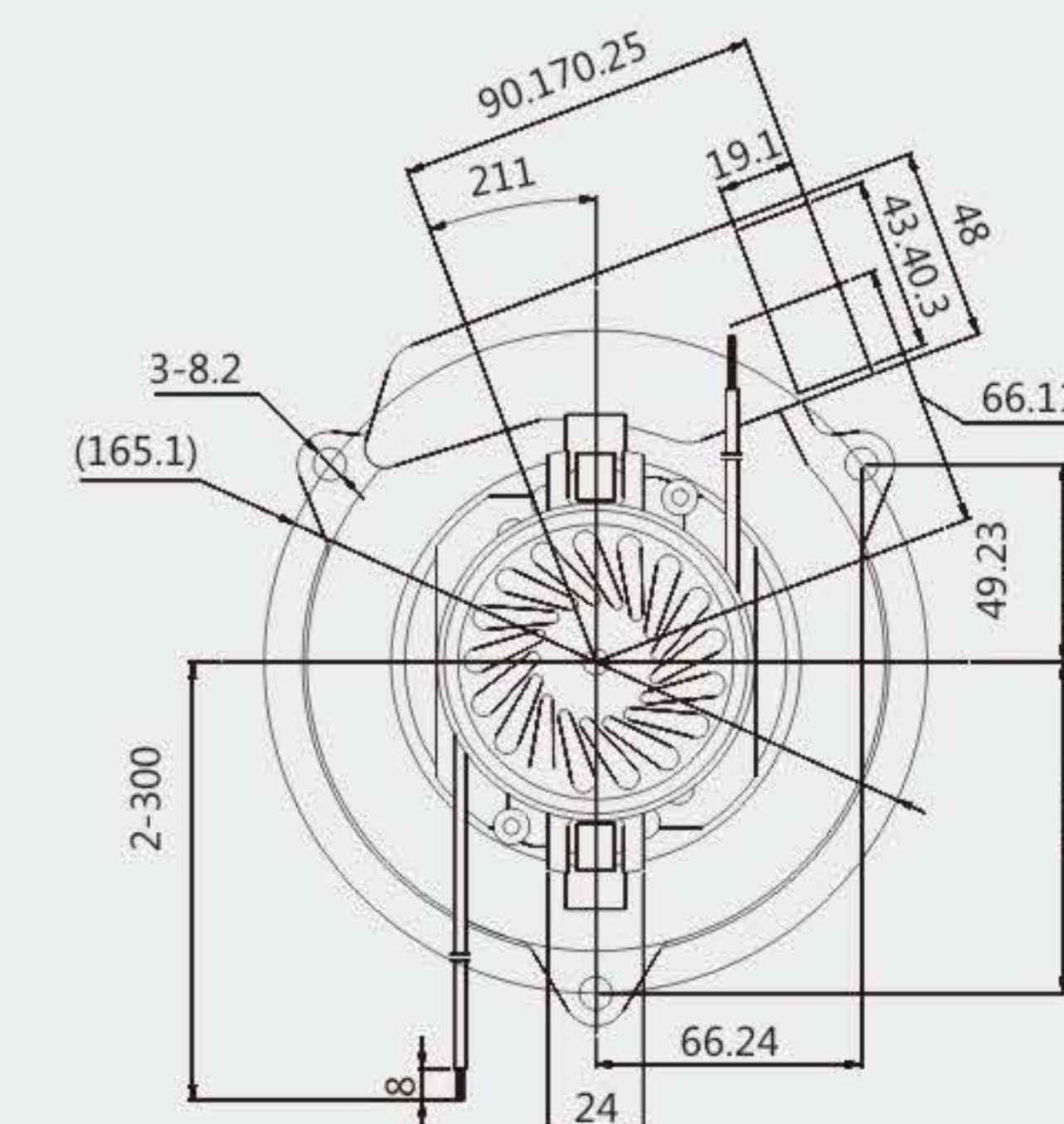
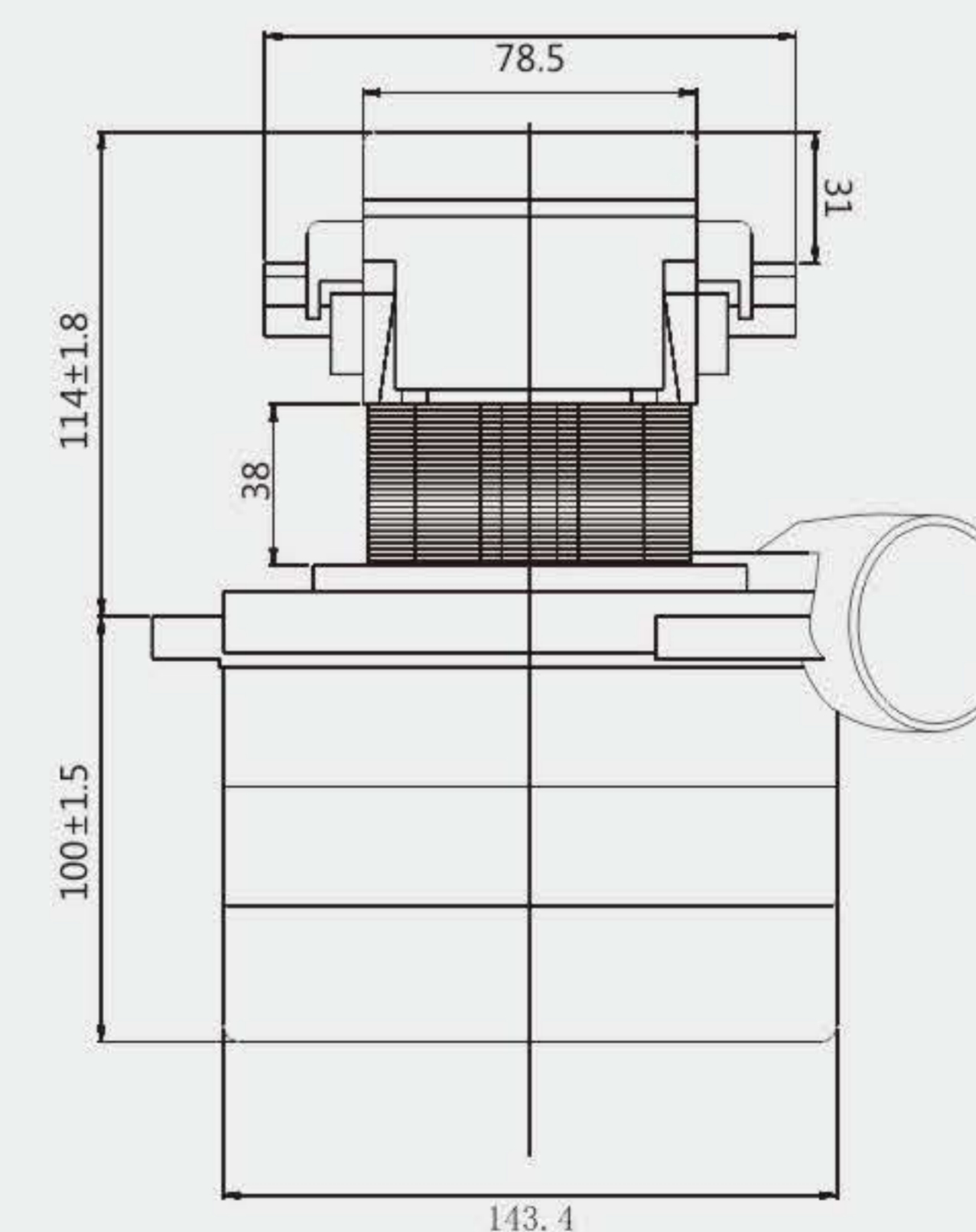
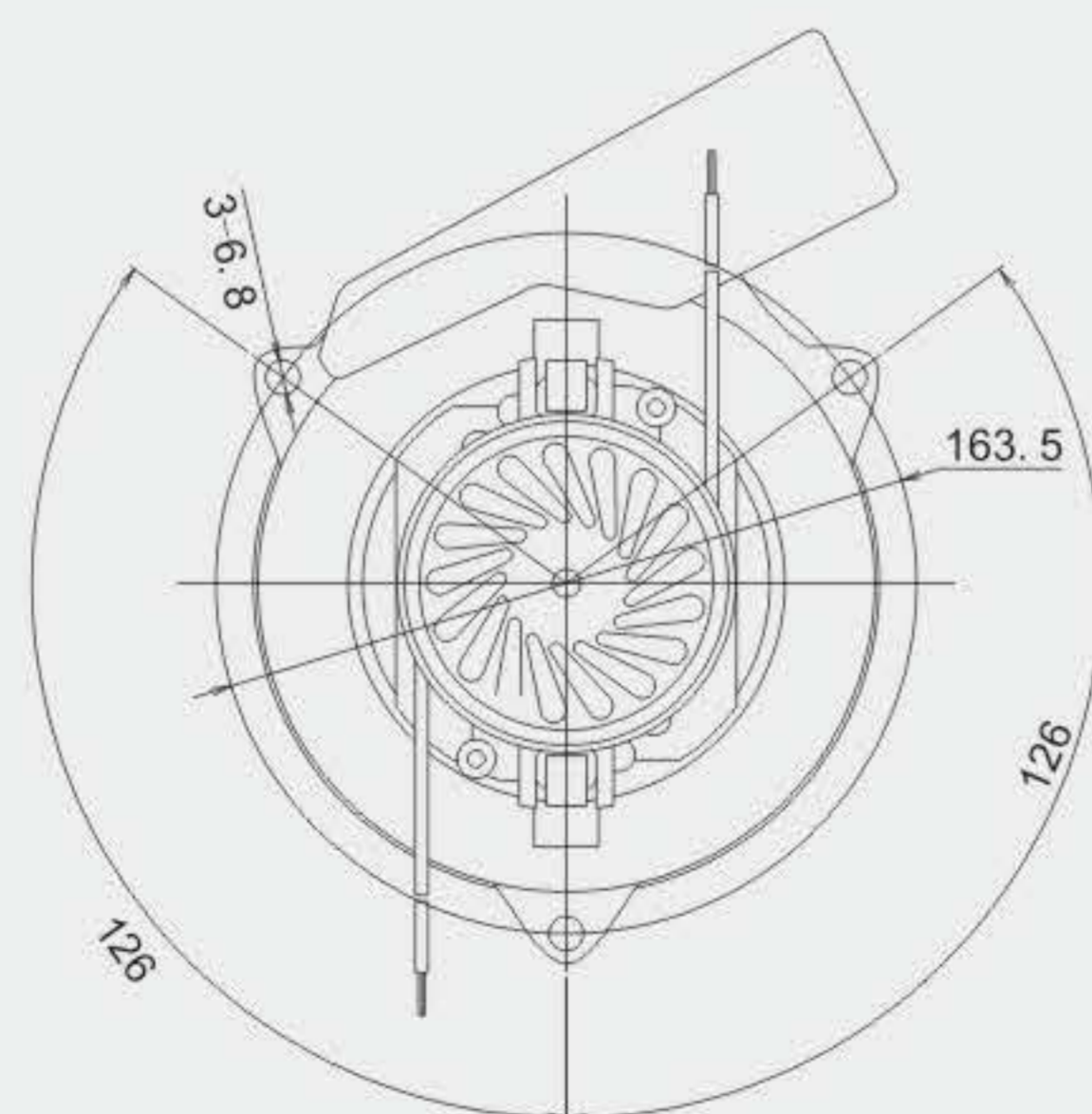
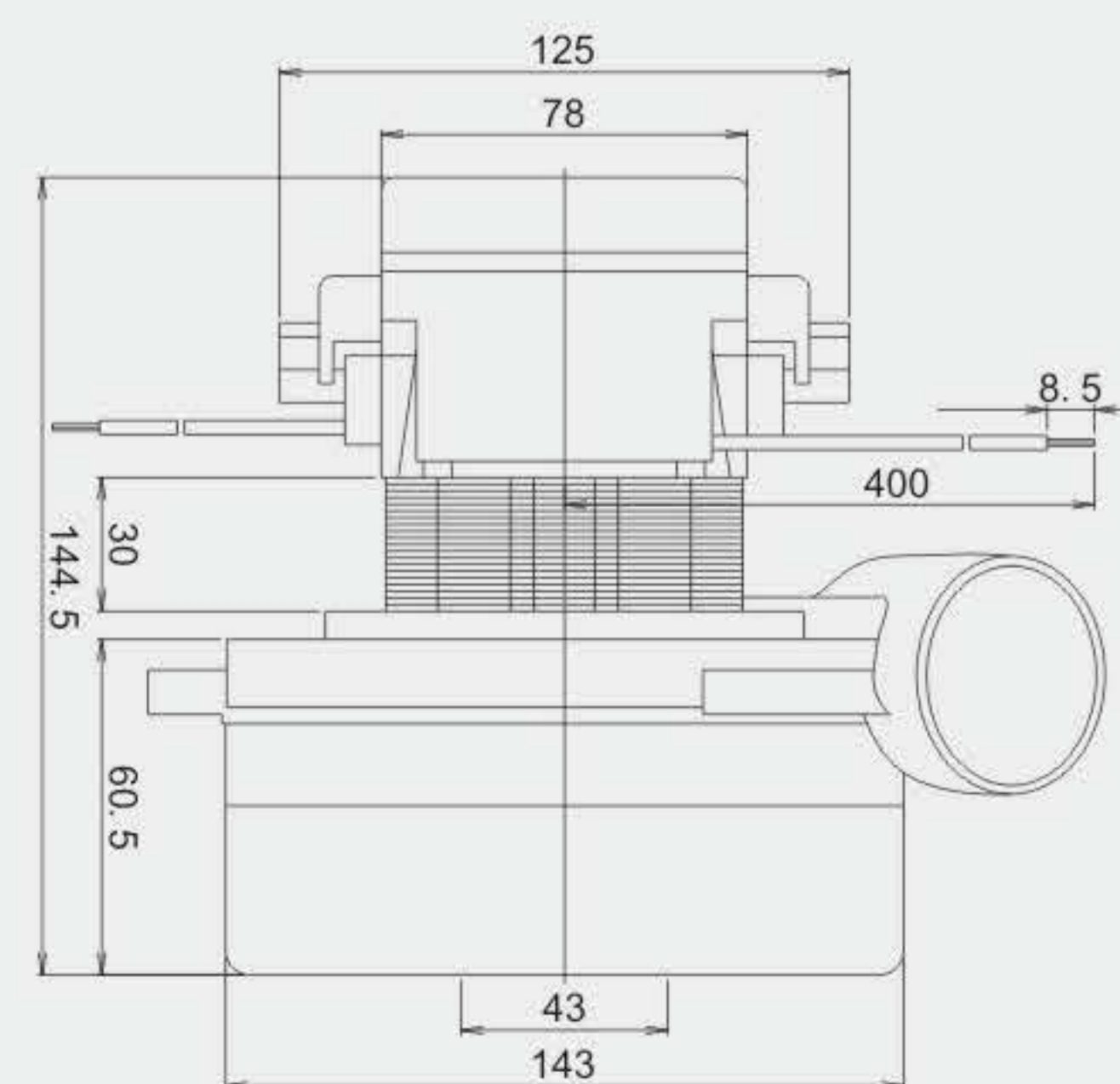

Typical Performance:

	Sealed Orifice	Orifice Loading	Max. Eff.
Orifice	0	19mm	19mm
Vacuum Pressure (mBar)	220	100	100
Air Flow ( CFM )	-	45	45
Airwatt (watt)	-	215	215
Speed (rpm)	18390	14780	14780
Input Power (watt)	576	748	748
Efficiency (%)	-	28. 7%	28. 7%

Typical Performance:

	Sealed Orifice	Orifice Loading	Max. Eff.
Orifice	0	19mm	19mm
Vacuum Pressure (mBar)	134	61. 5	61. 5
Air Flow ( CFM )	0	38. 5	38. 5
Airwatt (watt)	-	106	106
Speed (rpm)	17199	13360	13360
Input Power (watt)	367	434	434
Efficiency (%)	-	24. 7%	24. 7%



Motor Code MLGS3670 -03MA-GT

**Application**

Scrubber

**Characteristic**

- Voltage: 24V
- Fan system: Bypass Peripheral, 5.7 Inch, 3 stages
- Weight: 2740 g
- Certification: Provision for Grounding
- Feature: Air seal, coated Fan Shell, Interrupted brush



Motor Code MLGS3640 -03SA-GT

**Application**

Scrubber

**Characteristic**

- Voltage: 36V
- Fan system: Bypass Peripheral, 5.7 Inch, 2 stages
- Weight:
- Certification: Provision for Grounding
- Feature: Air seal, coated Fan Shell, Interrupted brush

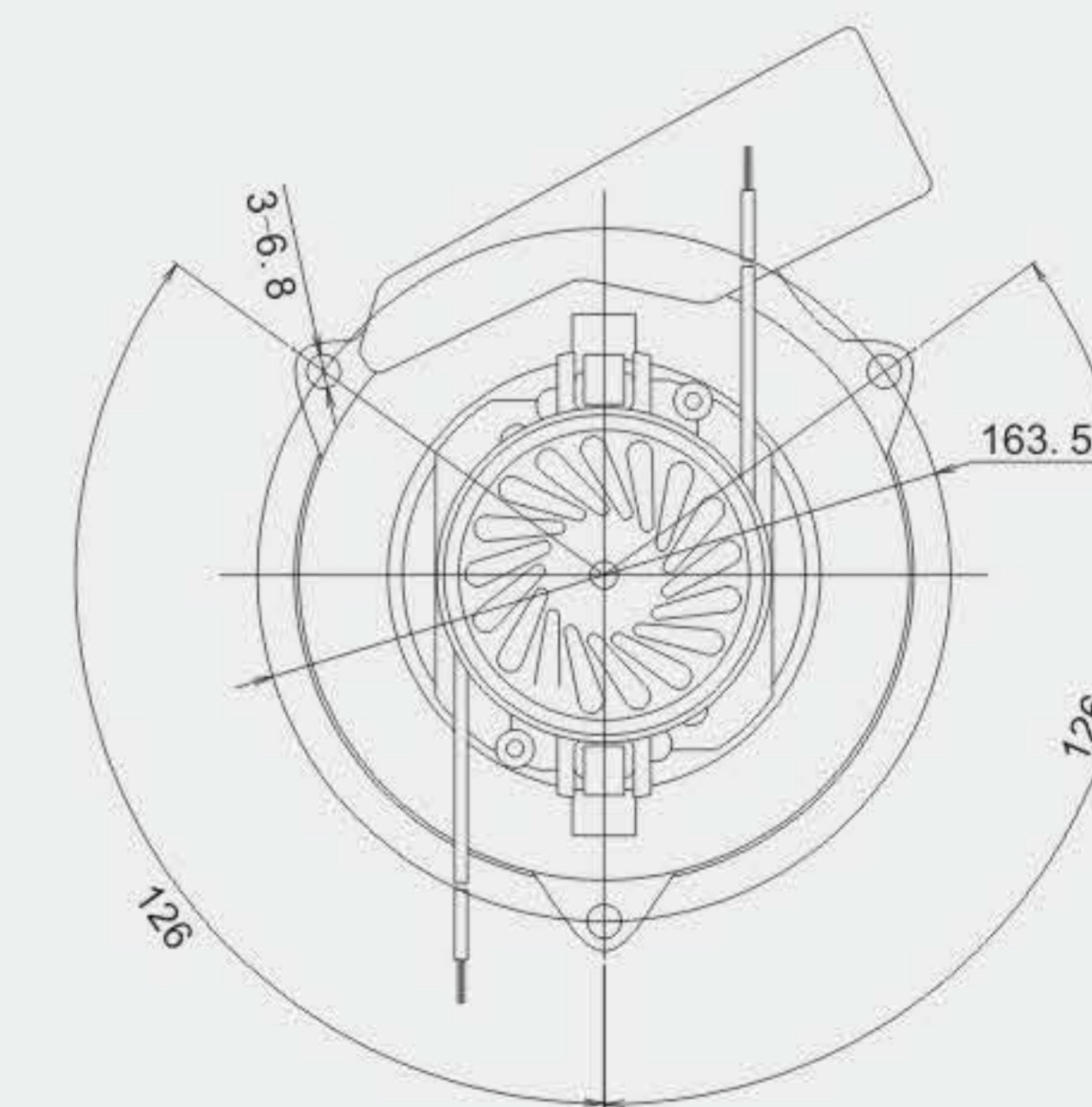
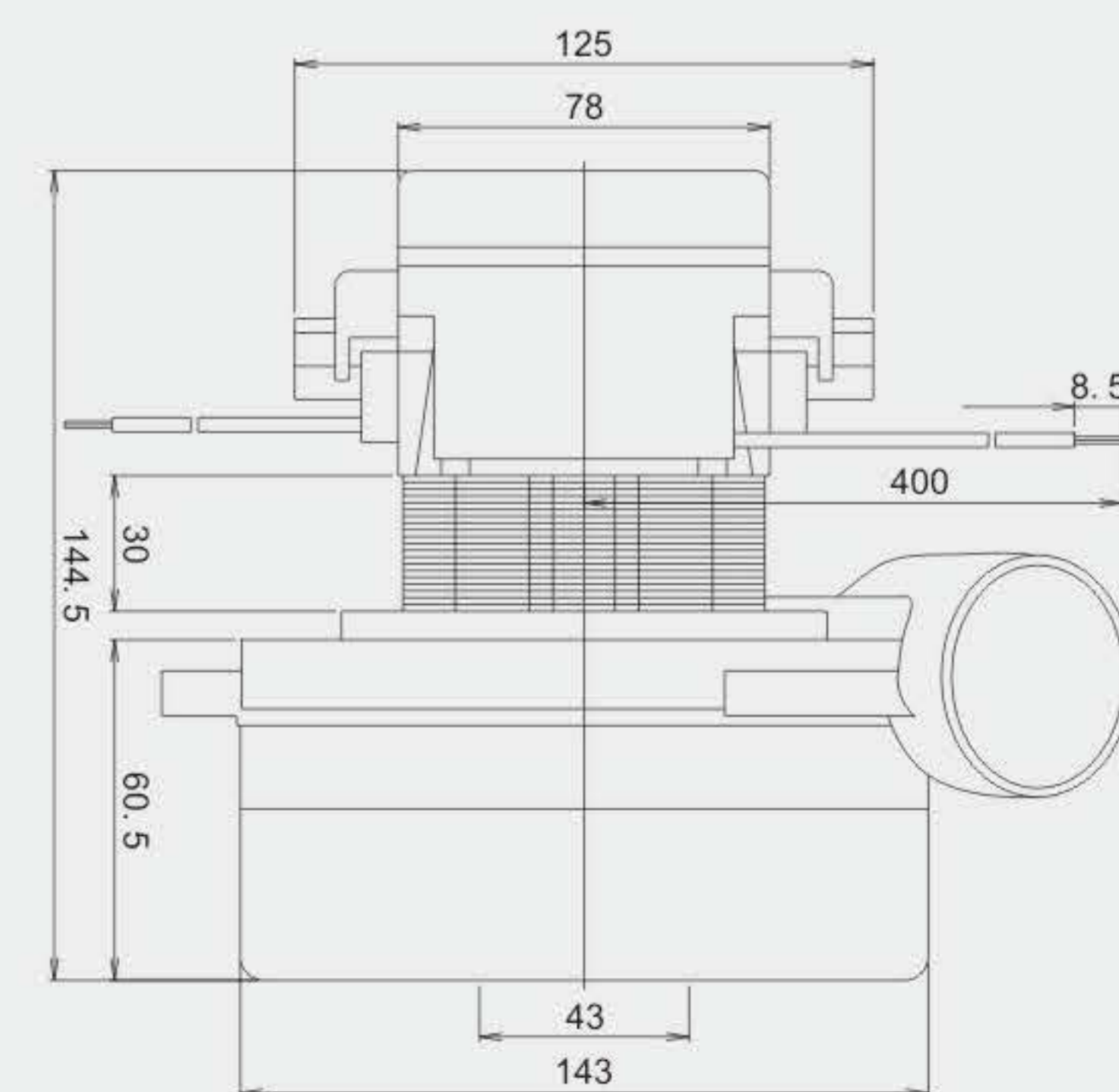
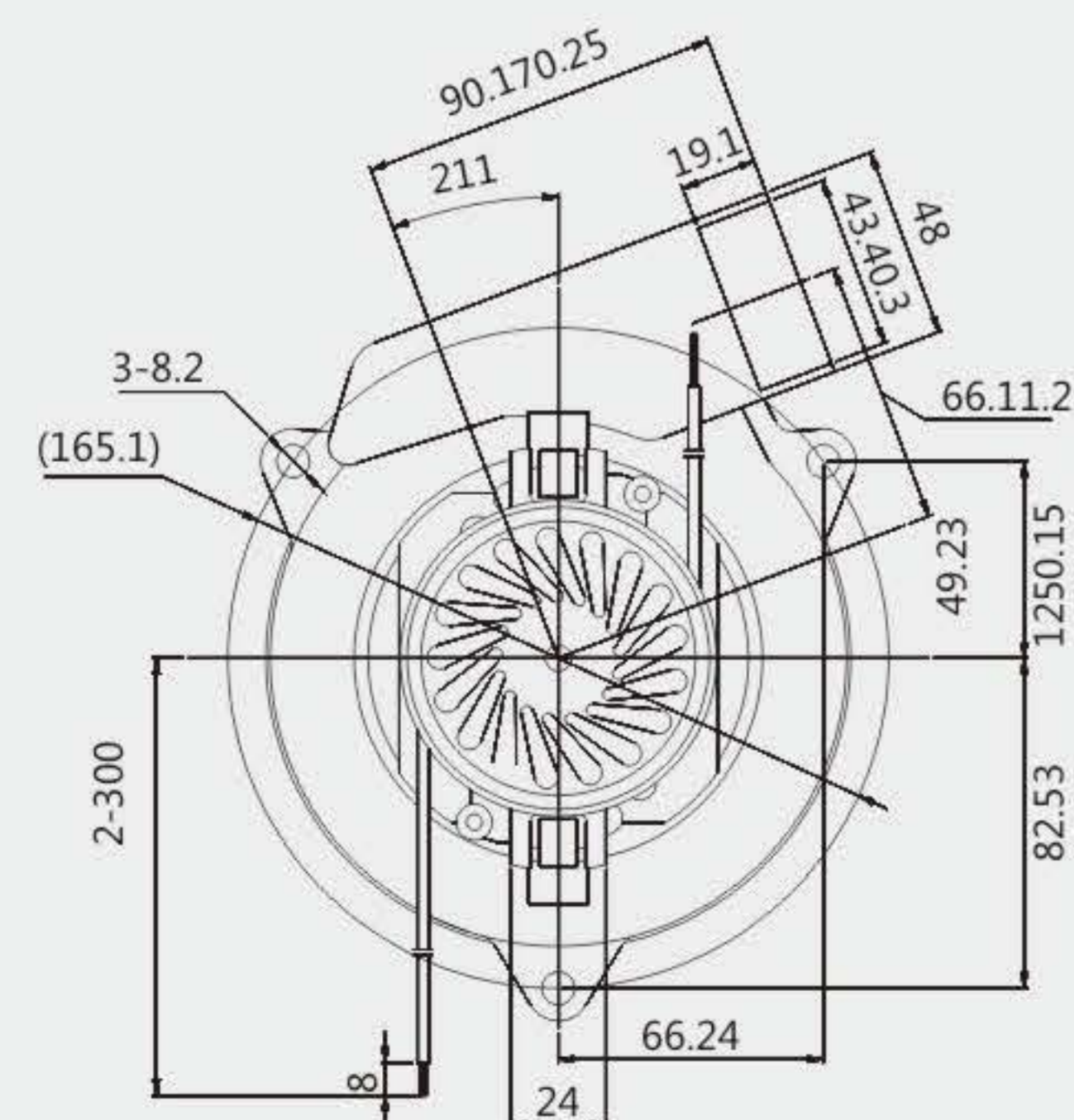
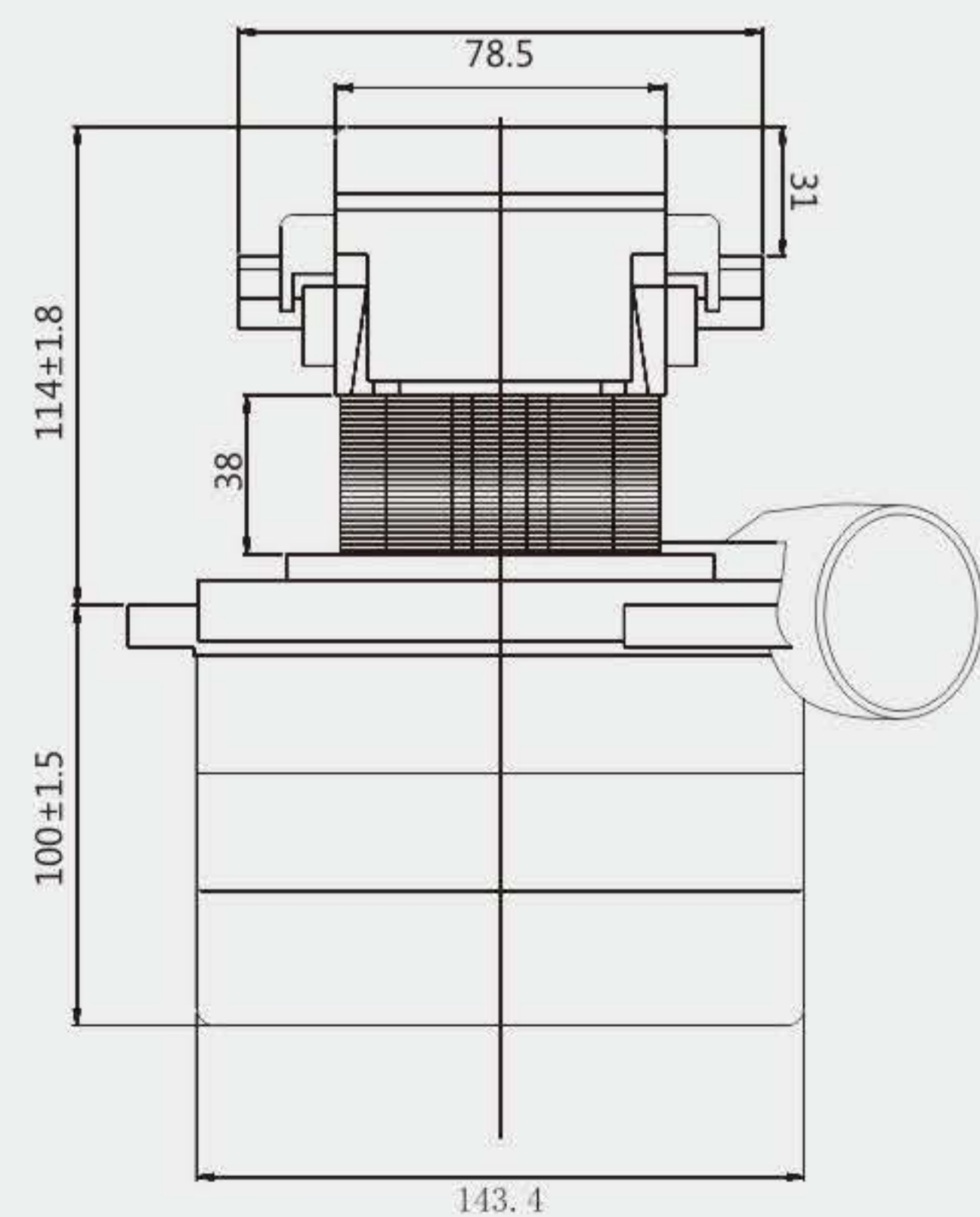

Typical Performance:

	Sealed Orifice	Orifice Loading	Max. Eff.
Orifice	0	19mm	19mm
Vacuum Pressure (mBar)	128	91	91
Air Flow ( CFM )	-	45.9	45.9
Airwatt (watt)	-	197	197
Speed (rpm)	31811	26083	26083
Input Power (watt)	725	894	894
Efficiency (%)	-	22%	22%

Typical Performance:

	Sealed Orifice	Orifice Loading	Max. Eff.
Orifice	0	19mm	19mm
Vacuum Pressure (mBar)	174	117	117
Air Flow ( CFM )	-	51.9	51.9
Airwatt (watt)	-	287	287
Speed (rpm)	31647	27909	27909
Input Power (watt)	766	940	940
Efficiency (%)	-	30.6%	30.6%



Motor Code MLGS23100 -05A

**Application**

Wet & Dry  
Industrial Vacuum  
Carpet Extractor

**Characteristic**

Voltage: 230V, 50/60Hz  
Fan system: Bypass Peripheral, 5.7 Inch, 1 stages  
Weight: 1544 g  
Certification: Provision for Grounding  
Feature: Air seal, coated Fan Shell, Interrupted brush



Motor Code MLGS23100 -01A

**Application**

Wet & Dry  
Upright

**Characteristic**

Voltage: 230V, 50/60Hz  
Fan system: Bypass Peripheral, 5.1 Inch, 1 stages  
Weight: 1485 g  
Certification: Provision for Grounding  
Feature: Air seal, coated Fan Shell, Interrupted brush

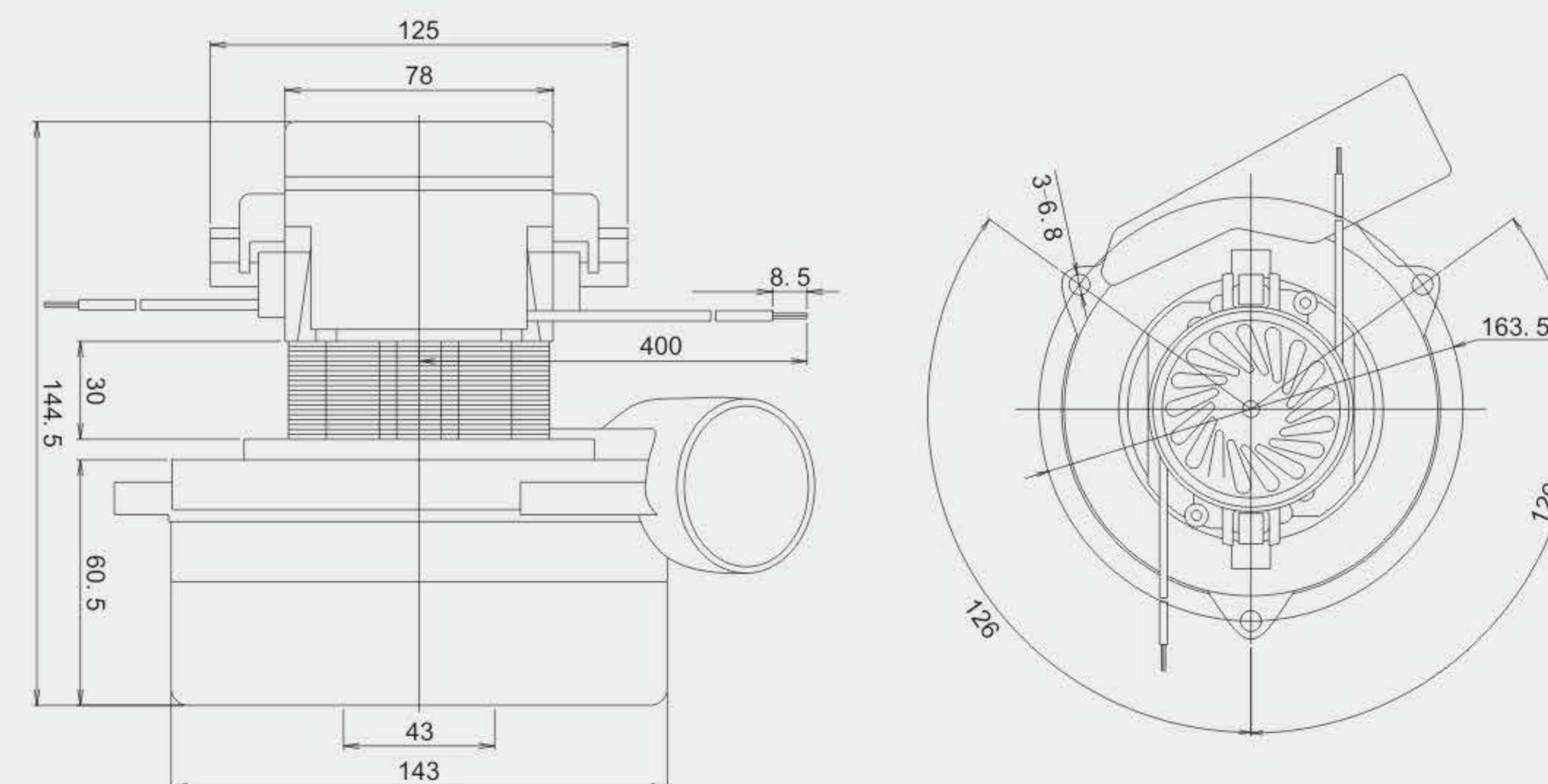
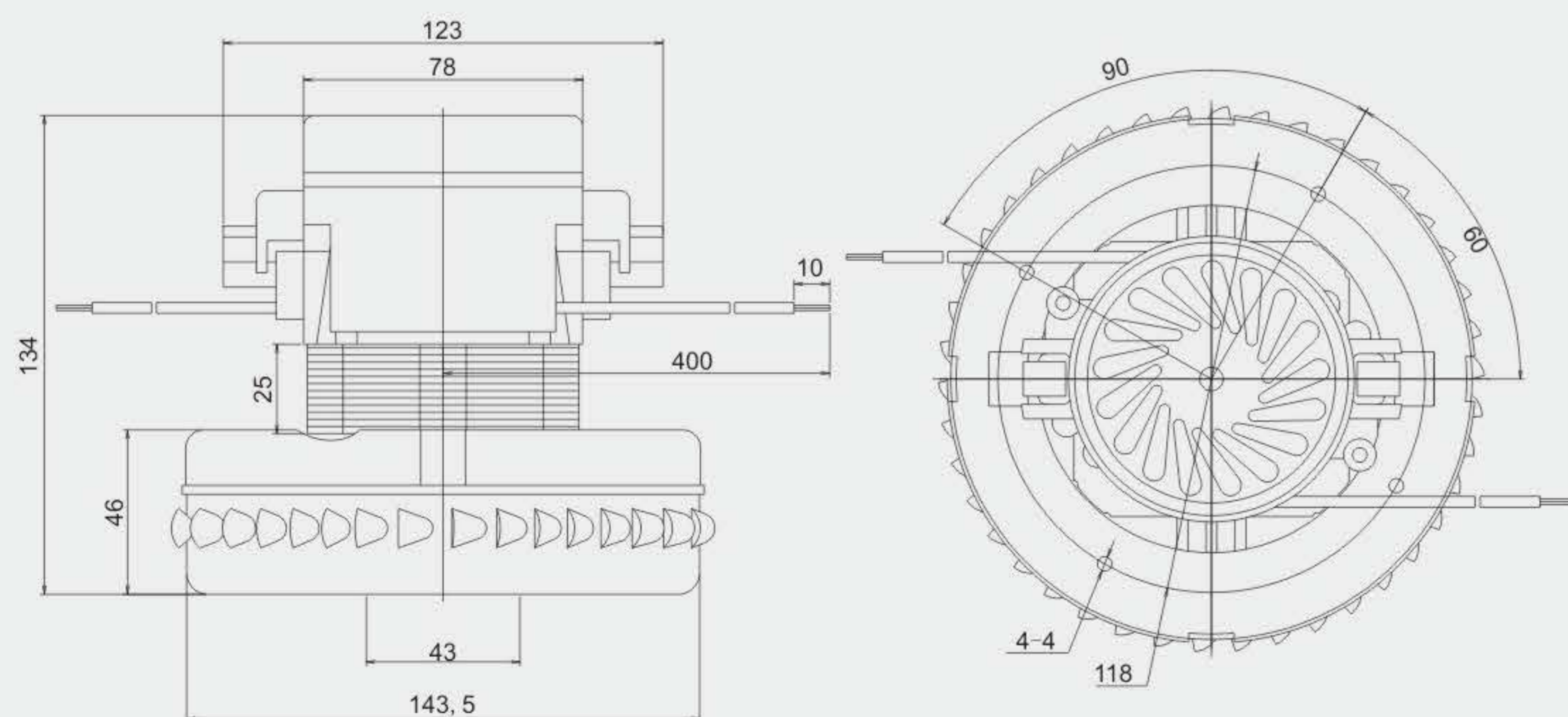

Typical Performance:

	Sealed Orifice	Orifice Loading	Max. Eff.
Orifice	0	19mm	16mm
Vacuum Pressure (mBar)	166	107	149
Air Flow ( CFM )	-	49.7	41
Airwatt (watt)	-	252	290
Speed (rpm)	38100	33370	35590
Input Power (watt)	581	730	656
Efficiency (%)	-	34.5%	44.1%

Typical Performance:

	Sealed Orifice	Orifice Loading	Max. Eff.
Orifice	0	19mm	23mm
Vacuum Pressure (mBar)	198	138	111
Air Flow ( CFM )	-	26	35
Airwatt (watt)	-	363	388
Speed (rpm)	34804	29708	29157
Input Power (watt)	870	1100	1130
Efficiency (%)	-	33%	34.3%



Motor Code MLGS2380 -D4

**Application**

Wet & Dry  
Upright

**Characteristic**

Voltage: 230V, 50/60Hz  
Fan system: Bypass Peripheral, 4.2 Inch, 1 stages  
Weight: 925 g  
Certification: Provision for Grounding  
Feature: Air seal, coated Fan Shell, Interrupted brush



Motor Code MLGS23100 -B

**Application**

Wet & Dry  
Upright

**Characteristic**

Voltage: 230V, 50/60Hz  
Fan system: Bypass Peripheral, 5.1 Inch, 1 stages  
Weight: 1221 g  
Certification: Provision for Grounding  
Feature: Air seal, coated Fan Shell, Interrupted brush

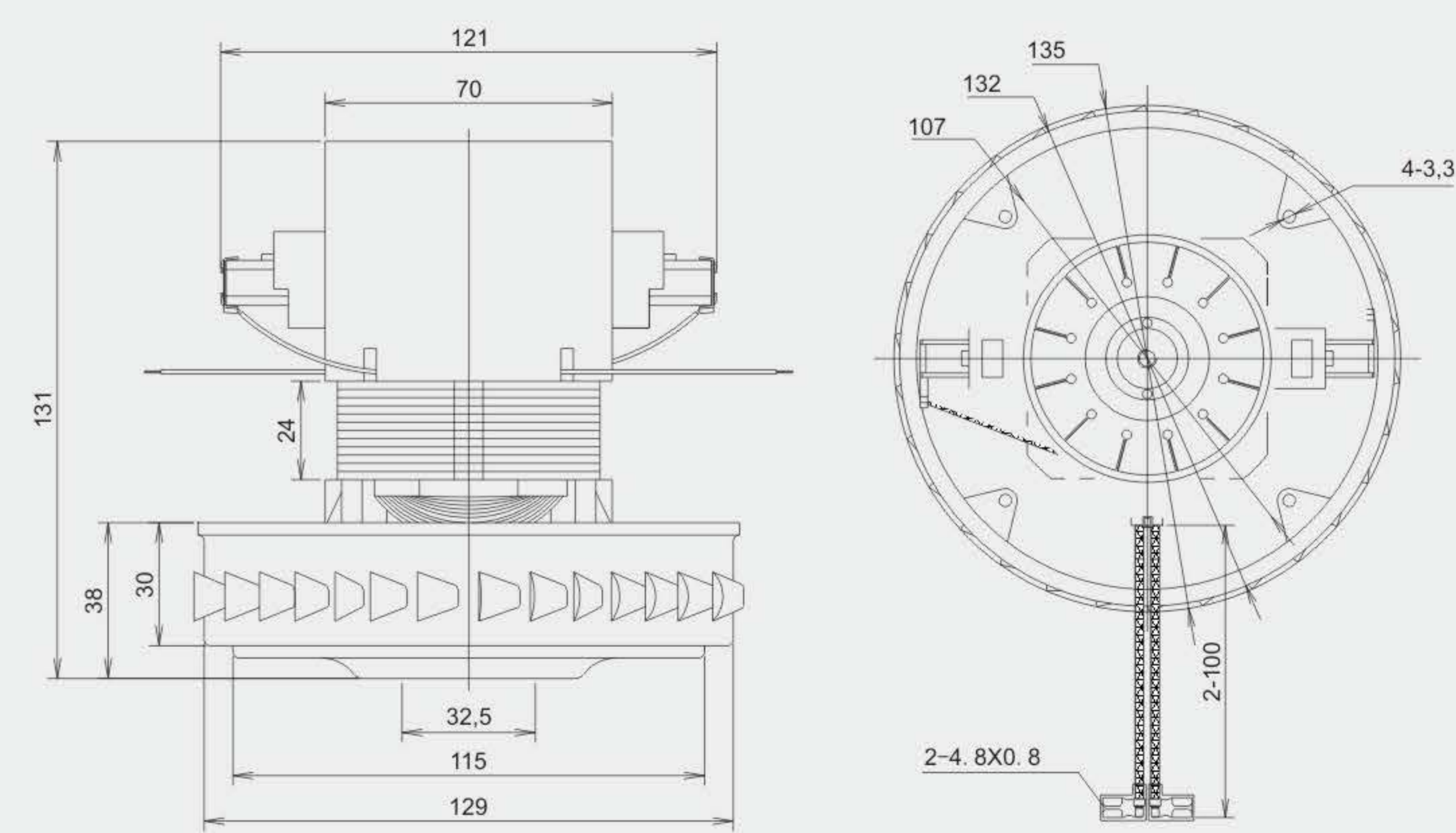
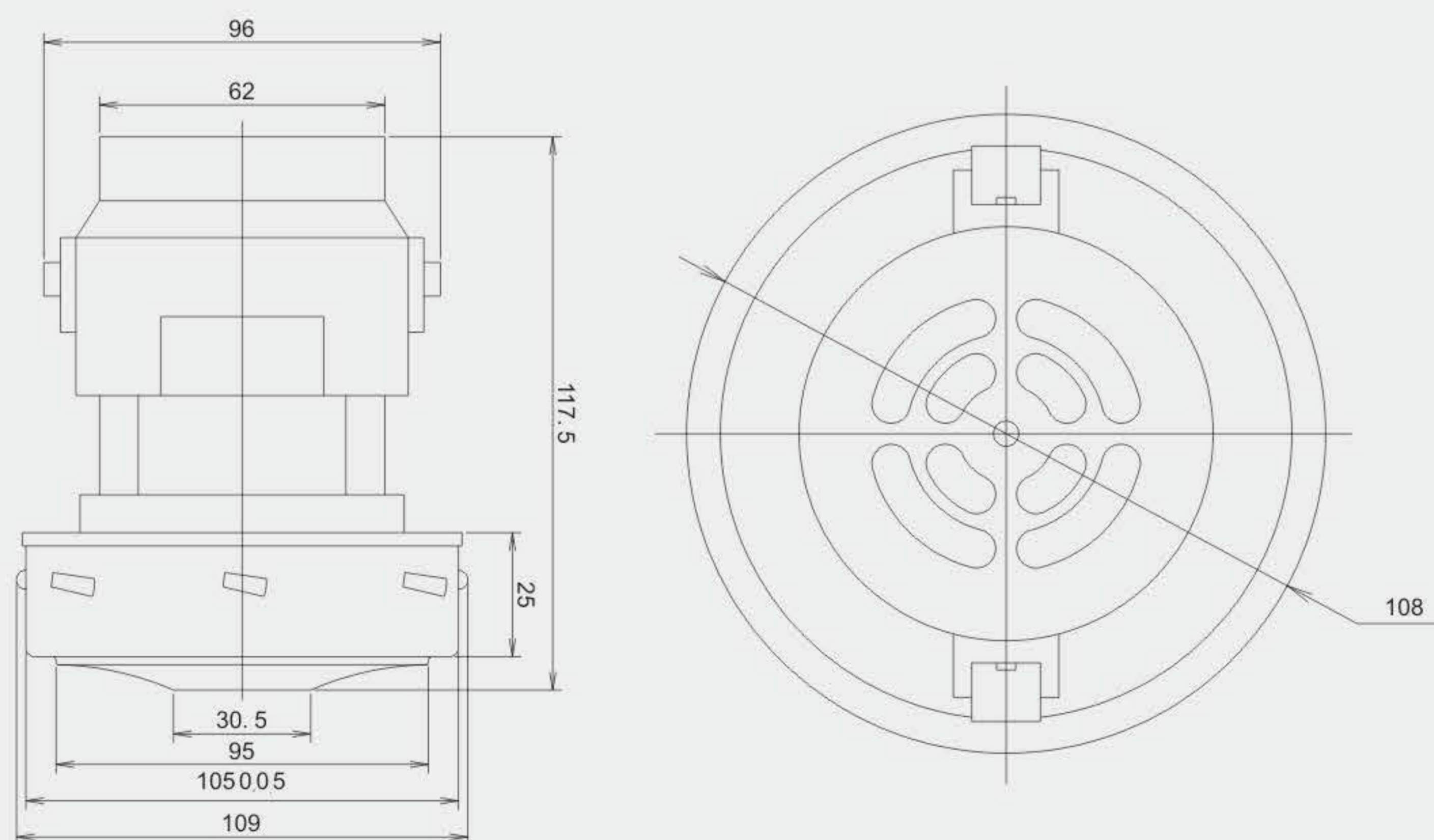

Typical Performance:

	Sealed Orifice	Orifice Loading	Max. Eff.
Orifice	0	19mm	19mm
Vacuum Pressure (mBar)	259	145	145
Air Flow ( CFM )	0	57	57
Airwatt (watt)	-	390	390
Speed (rpm)	39359	29365	29365
Input Power (watt)	861. 2	1133	1133
Efficiency (%)	-	34. 5%	34. 5%

Typical Performance:

	Sealed Orifice	Orifice Loading	Max. Eff.
Orifice	0	19mm	16mm
Vacuum Pressure (mBar)	116	59	78
Air Flow ( CFM )	0	37. 4	30. 5
Airwatt (watt)	-	104	113
Speed (rpm)	39629	33551	34268
Input Power (watt)	306	400	387
Efficiency (%)	-	26%	29%



Motor Code ML23120C

**Application**

Utilit Diy

**Characteristic**

Voltage : 230V, 50/60Hz  
 Fan system : Through Flow, 5. 4 Inch, 1 stages  
 Weight : 1280 g  
 Certification : Provision for Grounding  
 Feature : Air seal, coated Fan Shell, Interrupted brush



Motor Code MLGS2340-G

**Application**

Wet & Dry

**Characteristic**

Voltage : 230V, 50/60Hz  
 Fan system : Through Flow, 3. 35 Inch, 1 stages  
 Weight : 518 g  
 Certification : Provision for Grounding  
 Feature : Air seal, coated Fan Shell, Interrupted brush

